

PHASE 2

PHASE 1

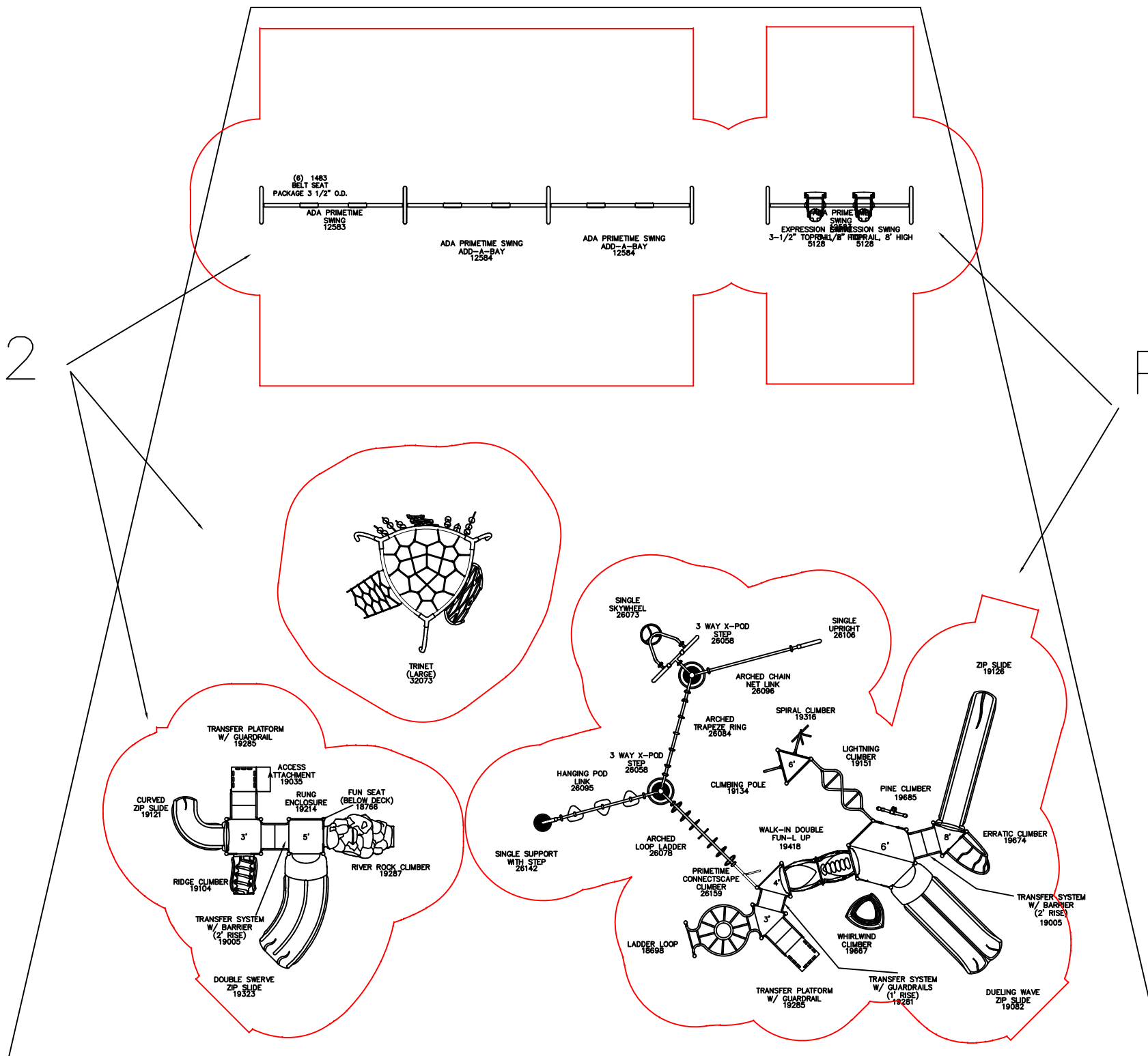

No.	Revision	Date

This play equipment is recommended for children ages 2-12 .

Soft, resilient surfacing should be placed in the use zones of all equipment, as specified for each type of equipment, and at depths to meet the critical fall heights as specified by the U.S. consumer Product Safety Commission, ASTM standard F 1487 and Canadian Standard CAN/CSA-Z-614.

This unit includes play events and routes of travel designed specifically for special needs users. It is the opinion of the manufacturer that these play events and routes of travel conform to the accessibility requirements of the ADA (American's with Disabilities Act).



Total Elevated Play Components	
Total Elevated Components Accessible By Ramp	Required
Total Elevated Components Accessible By Transfer	Required
Total Accessible Ground Level Components Shown	Required
Total Different Types Of Ground Level Components	Required

Drawn By:	Scale:
TA	1" = 5'-0"
Date:	
9/22/17	
Drawing Name:	